

**ISOMETRIC VIEW
(FRONT)**

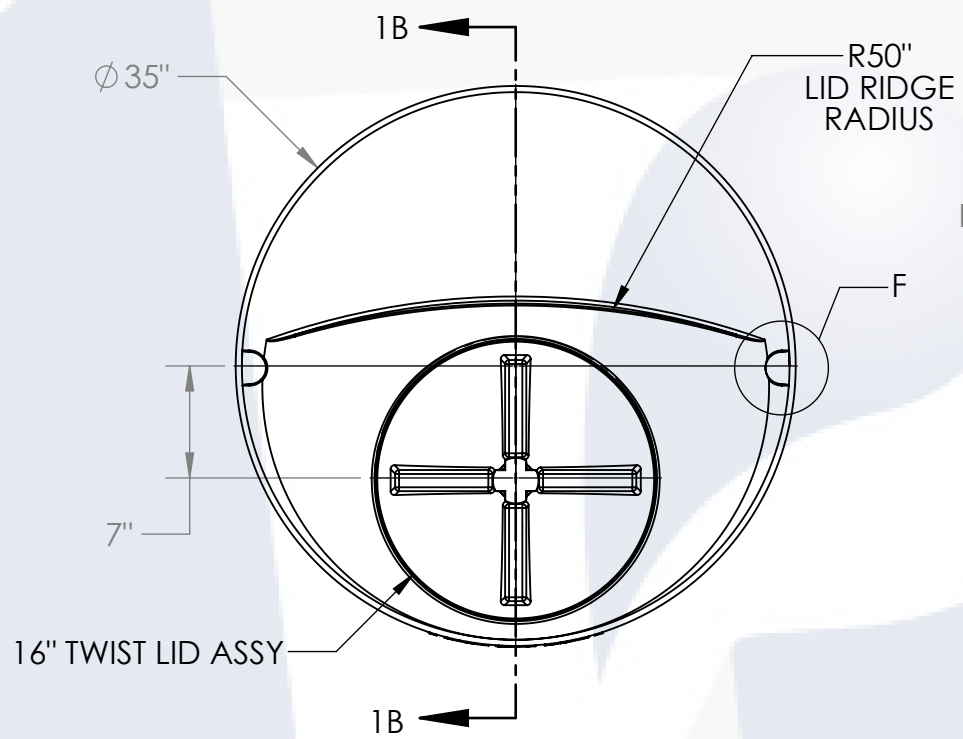

PLAN VIEW

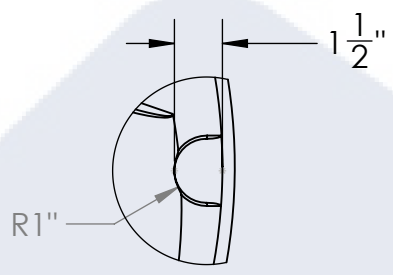

**DETAIL F
SCALE 1 : 6**

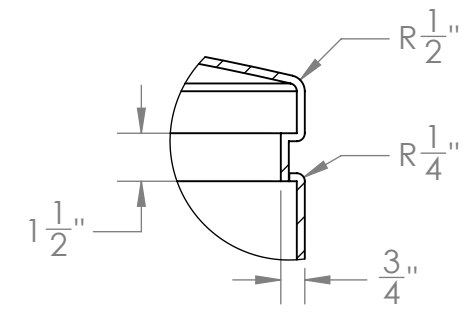

**DETAIL 1A
SCALE 1 : 6**

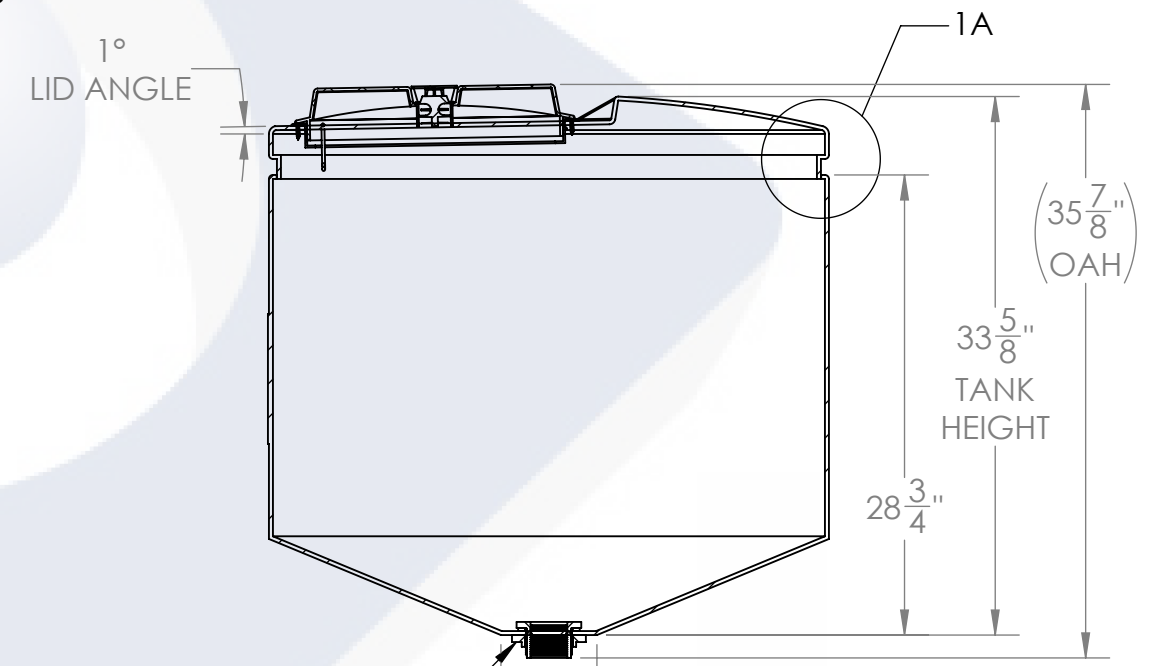

SECTION 1B-1B

- NOTES:**
1. CAPACITY: 100 GAL. NOMINAL
 2. TANK MATERIAL: XLPE
 3. SERVICE PRESSURE: ATMOSPHERIC
 4. NSF/ANSI STANDARD 61 CERTIFIED

PROPRIETARY AND CONFIDENTIAL
THE INFORMATION CONTAINED IN THIS DRAWING IS THE SOLE PROPERTY OF PEABODY ENGINEERING. ANY REPRODUCTION IN PART OR AS A WHOLE WITHOUT THE WRITTEN PERMISSION OF PEABODY ENGINEERING IS PROHIBITED.

UNLESS OTHERWISE SPECIFIED:
DIMENSIONS ARE IN INCHES
TOLERANCES: ±1/4"
ANGULAR: ± .5°
ONE PLACE DECIMAL: ± .25
TWO PLACE DECIMAL: ± .125
THREE PLACE DECIMAL: ± .063

TANK MATERIAL: **XLPE**

INNER TANK S/N:

OUTER TANK S/N:

CUSTOMER PO#

DO NOT SCALE DRAWING

	NAME	DATE
DRAWN	SMF	02/01/23
CHECKED		
ENG APPR.		
MFG APPR.		
Q.A.		

PROJECT: CONE BOTTOM TANKS		
CUSTOMER: PEABODY STANDARD		
SITE/LOCATION: -		
PART NUMBER: -		
SIZE	DESC.	REV.
B	100GAL CONE BOTTOM TANK	-
SCALE: 1:12		SHEET 1 OF 1